

Parts and Accessories Diagram

HMD900T-CE (Series A)

PROPRIETARY RIGHTS NOTICE This document and all information contained within it is the property of Hamilton Beach Brands, Inc. (HBB). It is confidential and proprietary and has been provided to you for a limited purpose. It must be returned or destroyed upon request. Disclosure, reproduction or use of this document and any information contained within it, in full or in part, for any purpose is forbidden without the prior written consent of HBB. No photographs may be taken of any article fabricated or assembled from this document without the prior written consent of HBB.

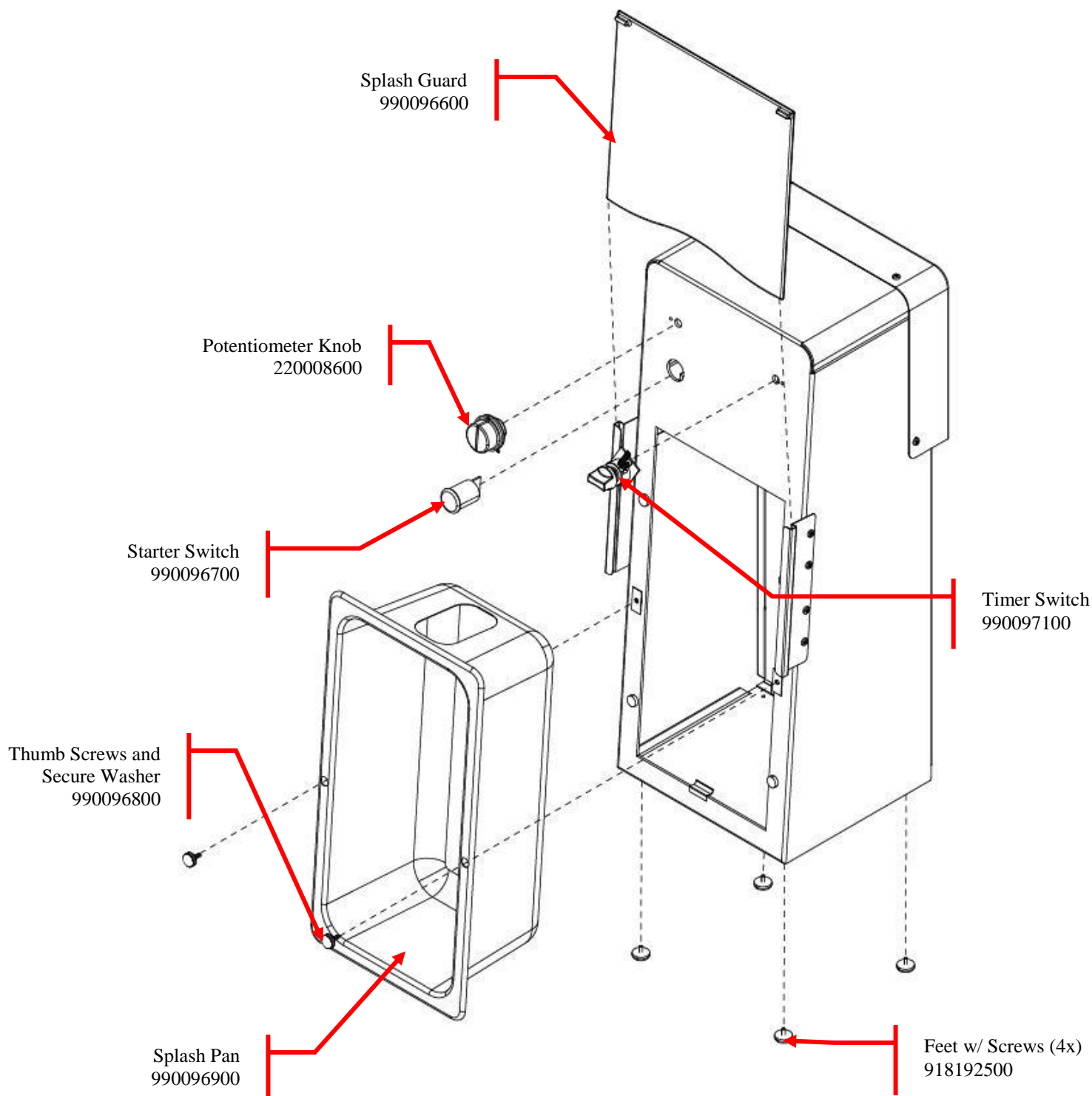

Hamilton Beach 4421 Waterfront Drive Glen Allen, VA 23060	Revision Description:		Change Motor p/n to 990054000					
	Request Number:	DOC6218	Revision Date:	1/21/16	Approved by:	DOC6218		
	Issue Code(s):	CS, SP	Page:	1 of 2	Document #:	540001800	Rev:	C

Parts and Accessories Diagram

HMD900T-CE (Series A)

PROPRIETARY RIGHTS NOTICE This document and all information contained within it is the property of Hamilton Beach Brands, Inc. (HBB). It is confidential and proprietary and has been provided to you for a limited purpose. It must be returned or destroyed upon request. Disclosure, reproduction or use of this document and any information contained within it, in full or in part, for any purpose is forbidden without the prior written consent of HBB. No photographs may be taken of any article fabricated or assembled from this document without the prior written consent of HBB.

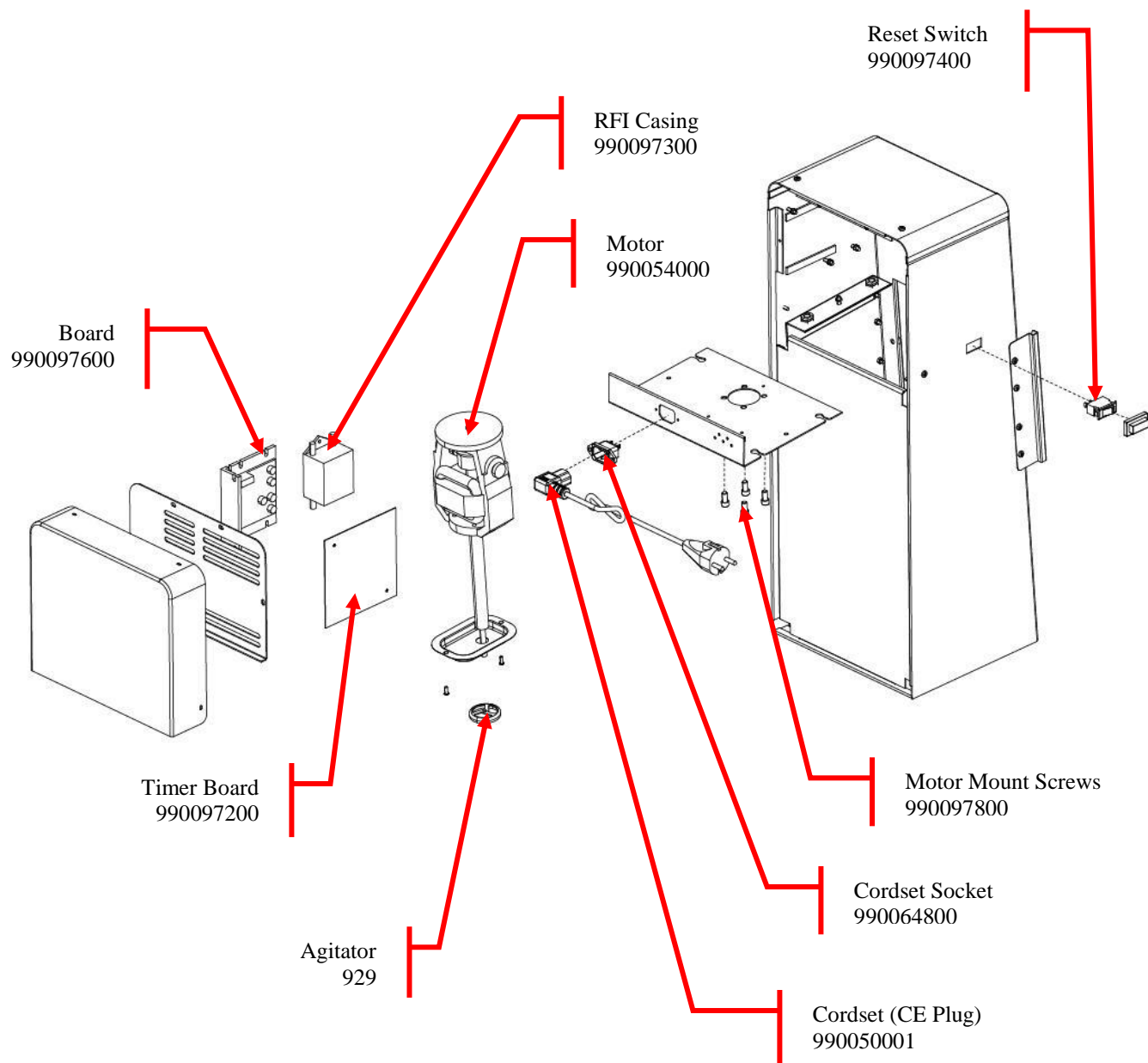

Not shown:

Motor Brush Kit – 990097700
 Potentiometer – 660024901
 Bumper (4x) - 35109490000

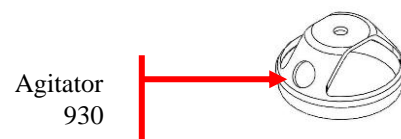

Hamilton Beach 4421 Waterfront Drive Glen Allen, VA 23060	Revision Description:		Change Motor p/n to 990054000					
	Request Number:		DOC6218		Revision Date:		1/21/16	
	Issue Code(s):		CS, SP		Page:		2 of 2	
				Document #:		540001800		Rev: C